

General Characteristics

- ▶ The VentDepot ComfortCooler is fabricated from heavy steel with a baked powder coat finish; these fans are durable and whisper quiet.
- ▶ Two-speed motor, wall switch is standard with two-speed fan.
- ▶ Includes Wood frame 1" x 4" (Ready to install)
- ▶ Rubber damper between fan and wood frame for quieter operation
- ▶ Heavy gauge steel welded construction
- ▶ Die cast aluminum hub and balanced blades
- ▶ Optional shutter to eliminate joist cutting on fans up to and including 42"

Applications

- ▶ For commercial and home use:
- ▶ Used to ventilate attic space and to remove heat from homes, shops, or garages.

Warranty

- ▶ Limited Warranty: 10 Years in the USA.



VentDepot.com

Product Data Sheet

Item #	Ø in	CFM		RPM		HP	Volts	Amps	Speed motor	Weight lbs	Shipping Size L,W,H (in.)
		High	Low	High	Low						
USCFM-001	24	5600	3700	560	370	1/3	115	6.7	2	57	32,32,17
USCFM-002	30	7600	5100	455	305	1/3	115	6.7	2	62	36,36,17
USCFM-003	30	8400	5600	460	305	1/2	115	8.2	2	67	36,36,17
USCFM-004	36	9700	6400	420	280	1/3	115	6.7	2	77	42,42,17
USCFM-005	36	10600	7100	415	275	1/2	115	8.2	2	82	42,42,17
USCFM-006	42	12600	8400	410	270	1/2	115	8.2	2	91	48,48,17
USCFM-007	48	14500	9700	305	200	1/2	115	8.2	2	107	54,54,17

Dimensions

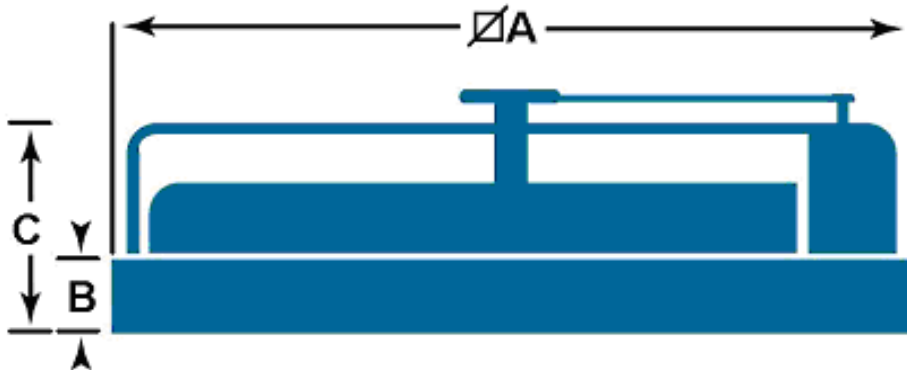

Item #	Ø A	B	C
USCFM-001	30"	4"	15"
USCFM-002	34"	4"	15"
USCFM-003	34"	4"	15"
USCFM-004	40"	4"	15"
USCFM-005	40"	4"	15"
USCFM-006	46"	4"	15"
USCFM-007	52"	4"	15"

Air Flow

